

Safe-Cell® Drinking Outlet

PRODUCT CODES:

- 50057US
- 50069US

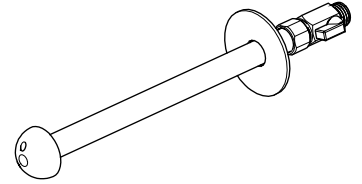

SPECIFICATIONS

- The Safe-Cell® Drinking/Basin Outlet is made of DR Brass with a chrome plated outlet dome.
- Galvin Specialised recommends the installation of strainers and pressure reducing valves prior to installing the drinking and basin outlets to ensure clean consistent supply. Debris or poor water quality could cause the taps to seize or fail.

IMPORTANT: All Safe-Cell® Prison taps are tested and leave our premises in good working order.

TECHNICAL DATA

Inlet	½" 14 NPT – Male	
Outlet	Drinking/Basin	
Headwork	N/A	
Working Pressure Range (kPa)	Min	50
	Max	500
Working Temperature Range (°C)	Min	5
	Max	70
Nominal Flow Rate (LPM)	50057US	N/A
	50069US	N/A
Construction	DR Brass	
Finish	Chrome	

NOTE: Galvin Specialised continually strive to improve their products. Specifications may change without notice.

TOOLS REQUIRED

- Power drill
- Spanner or adjustable crescent

PRE-INSTALLATION

MOUNTING DETAILS

- If the mounting holes do not already exist, mark out and drill the holes in the bench/trough, as shown in rough-in dimensions.
- Ensure alignment of 4mm hole is as required, as this will determine direction of water flow.

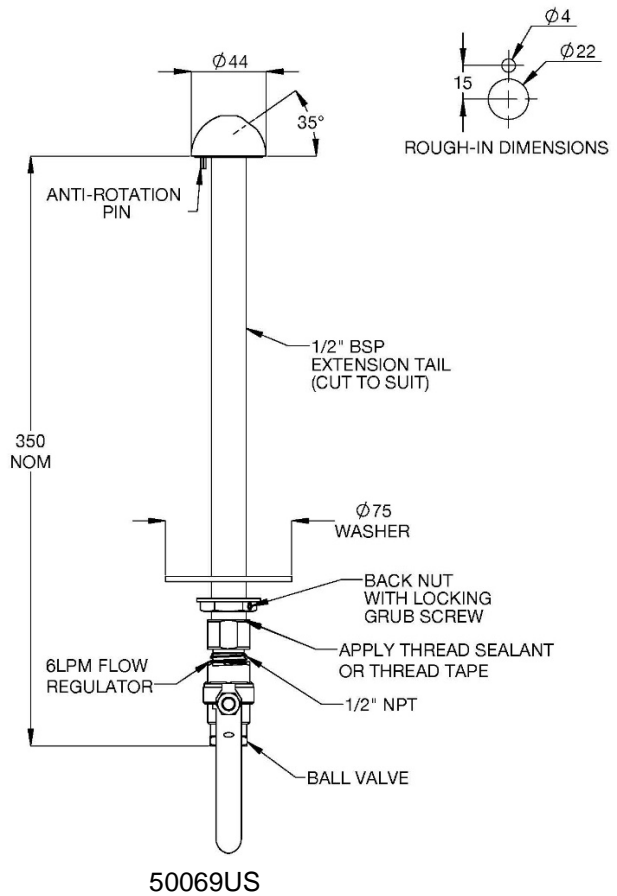
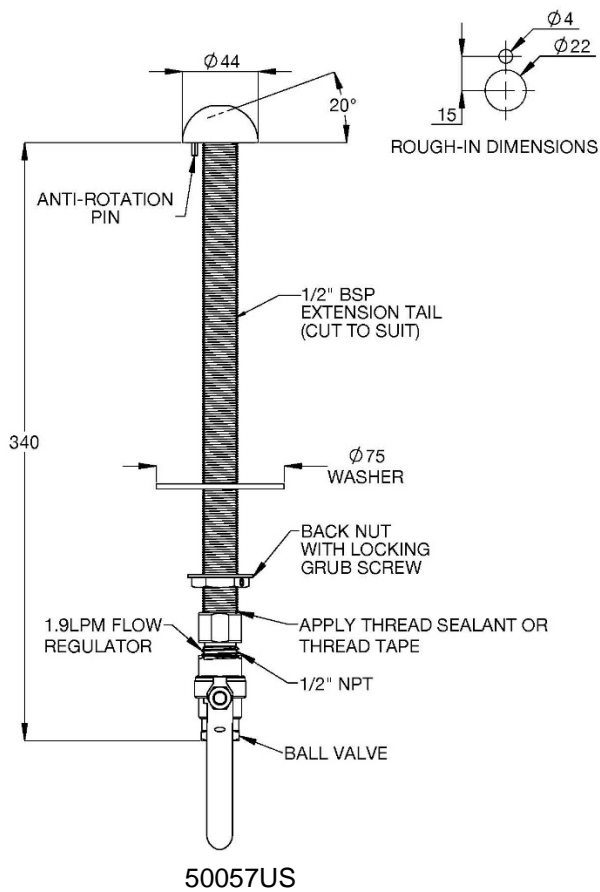

INSTALLATION

INSTALLATION COMPLIANCE: Galvin Specialised products must be installed in accordance with these installation instructions your local regulatory requirements. Water and/or electrical supply conditions must also comply to the applicable national and/or state standards. Failing to comply with these provisions shall void the product warranty and may affect the performance of the product.

IMPORTANT: Whilst our product designs take into account a broad range of installation types and surfaces, it is important that surfaces which fixtures are mounted to are flat and free from defect. This is especially important when installing product ranges that have been designed for correctional and health facilities, where special attention is required to minimise ligature points and areas for concealment of contraband. In addition to ensuring the products are fitted securely and in accordance with the following instructions, consideration shall be given to the use of non-pick mastics such as BASF Sonolastic “Ultra” to ensure a high quality and safe installation.

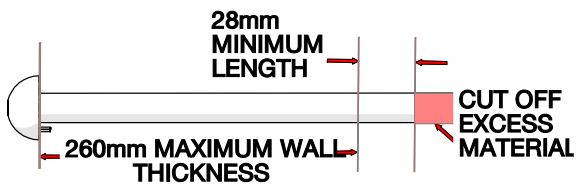

1. Measure extension nipple

- Insert outlet through the wall and mark for cutting if too long.
- Ensure a minimum of 28mm is protruding from the wall and cut where marked, remove any burrs.

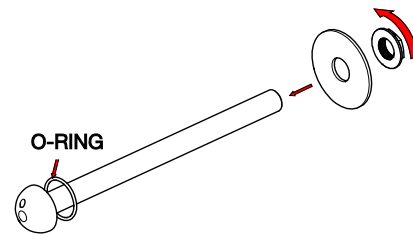

2. Fit outlet

- Re-insert the outlet through the wall and secure using the large galvanised washer and flanged back nut.
- Ensure the o-ring is fitted between the wall and the domed outlet.

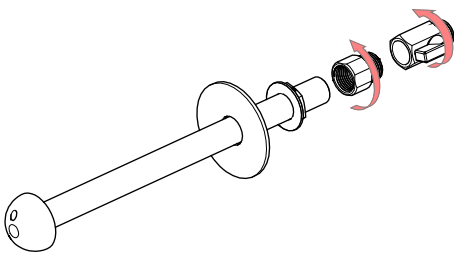

3. Fit restrictor housing

- Fit the restrictor housing and the regulating valve to the outlet, use thread sealant or thread tape for sealing.
- Ensure excess sealing is removed and that the regulating valve is not over tightened.

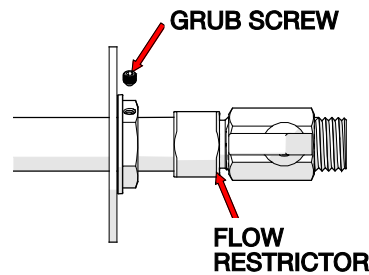

4. Fit the grub screws

- Fit the supplied grub screw into the flanged back nut and lock securely.

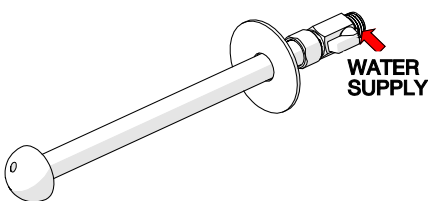

5. Testing

- Connect water supply to isolation valve inlet.
- Inspect the tap and check for any leaks.
- Adjust flow with isolation valve, to achieve required flow.

TROUBLESHOOTING

PROBLEM	CAUSE	RECTIFICATION
Water is not flowing or inconsistent flow	Blocked flow restrictor	Remove flow regulator from outlet and remove debris. Install an inline strainer to stop further blockage
Rate of flow inadequate	The flow restrictor may not be satisfactory due to inadequate supply pressure	Remove flow restrictor and replace with a flow restrictor of different capacity to suit
	Isolation valve not adjusted	Adjust isolation valve to achieve desired flow

WARRANTY

The warranty set forth herein is given expressly and is the only warranty given by the Galvin Engineering Pty Ltd. With respect to the product, Galvin Engineering Pty Ltd makes no other warranties, express or implied. Galvin Engineering Pty. Ltd. hereby specifically disclaims all other warranties, express or implied, including but not limited to the implied warranties of merchantability and fitness for a particular purpose.

Galvin Engineering Pty Ltd products are covered under our manufacturer’s warranty available for download from www.galvinengineering.com.au Galvin Engineering Pty Ltd expressly warrants that the product is free from operational defects in workmanship and materials for the warranty period as shown on the schedule in the manufacturer’s warranty. During the warranty period, Galvin Engineering will replace or repair any defective products manufactured by Galvin Engineering without charge, so long as the terms of the Manufacturer’s warranty are complied with.

The remedy described in the first paragraph of this warranty shall constitute the sole and exclusive remedy for breach of warranty, and Galvin Engineering Pty Ltd shall not be responsible for any incidental, special or consequential damages, including without limitation, lost profits or the cost of repairing or replacing other property which is damaged if this product does not work properly, other costs resulting from labour charges, delays, vandalism, negligence, fouling caused by foreign material, damage from adverse water conditions, chemical, electrical or any other circumstances over which Galvin Engineering has no control. This warranty shall be invalidated by any abuse, misuse, misapplication, improper installation or improper maintenance or alteration of the product.